



# ROUND ICE MAKER SUPPLY BOX TECHNICAL SPECIFICATION

Job Name _____	Item # _____
Location _____	
Engineer _____	Contractor _____
PO # _____	Tag _____
Representative _____	

## SPECIFICATIONS

Oatey's Ice Maker Supply Box shall be used in commercial or residential applications which require supply valves recessed into the wall. Provides a quick, safe water supply and shut-off for refrigerator ice maker and water dispenser. Stainless steel hoses included in select SKUs.

## APPROVALS AND LISTINGS

Valves	NSF Standard 61, Section 9
Hammer Arrestors	ASSE 1010
Boxes	IAPMO Listed



## FEATURES & MATERIALS

Box Material	High Impact Polystyrene
Hose Material	Stainless Steel
Faceplate	7-3/8" Diameter
Snap-On Faceplate	Accommodates up to 1" Drywall

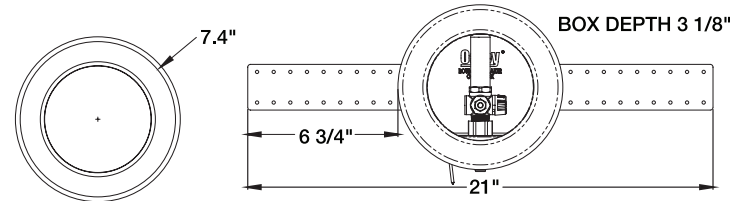
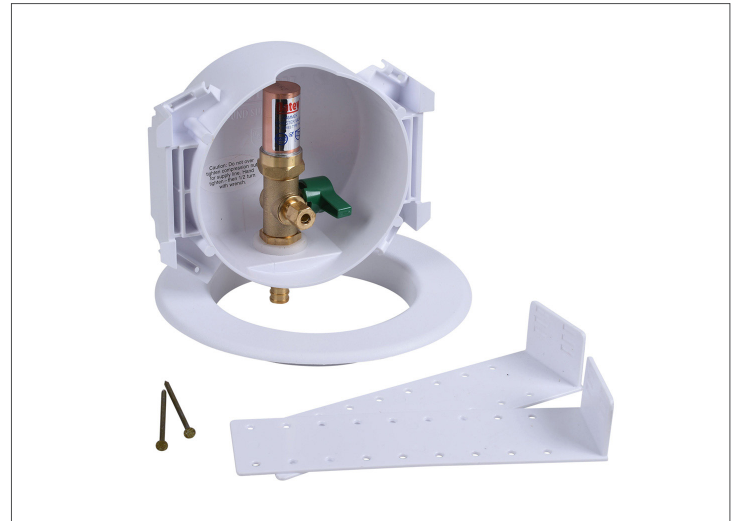

## PRODUCT SELECTOR

ROUND ICE MAKER SUPPLY BOX			CTN. QTY.
✓	<b>Product Number</b>	<b>Description</b>	
	<b>ROUND ICE MAKER SUPPLY BOX</b>		
	39207	1/4 Turn Brass Ball Valve - Low Lead - Copper Sweat - Standard Pack	6
	39208	1/4 Turn Brass Ball Valve - Low Lead - CPVC - Standard Pack	6
	39209	1/4 Turn Brass Ball Valve - Low Lead 1/2" ASTM F1807 Pex Standard Pack	6
	39210	1/4 Turn Brass Ball Valve - Low Lead 1/2" ASTM F1960 Pex Standard Pack	6
	39211	1/4 Turn Brass Hammer Ball Valve - Low Lead - Copper Sweat - Standard Pack	6
	39212	1/4 Turn Brass Hammer Ball Valve - Low Lead - CPVC Standard Pack	6
	39213	1/4 Turn Brass Hammer Ball Valve - Low Lead 1/2" ASTM F1807 Pex Standard Pack	6
	39214	1/4 Turn, Round, F1960 Hammer, Low Lead - Standard Pack	6
	<b>ROUND ICE MAKER SUPPLY BOX WITH STAINLESS STEEL HOSE</b>		
	39265	Round IMOB 1/4 Turn Copper Contractor Pack, Stainless Steel Hose LL	12
	39267	Round IMOB 1/4 Turn CPVC Standard Pack, Stainless Steel Hose LL	6
	<b>ACCESSORIES</b>		
	39215	Round Ice Maker Outlet Box Face Plate	6
	39216	Plain Box - Standard Pack - No Valve	6
	38648	Brackets 12" Long Plastic	12

Access BIM/Revit content through [www.oatey.com](http://www.oatey.com)